

# **THE EXETER**

**AREA 90 SQ MTRS**

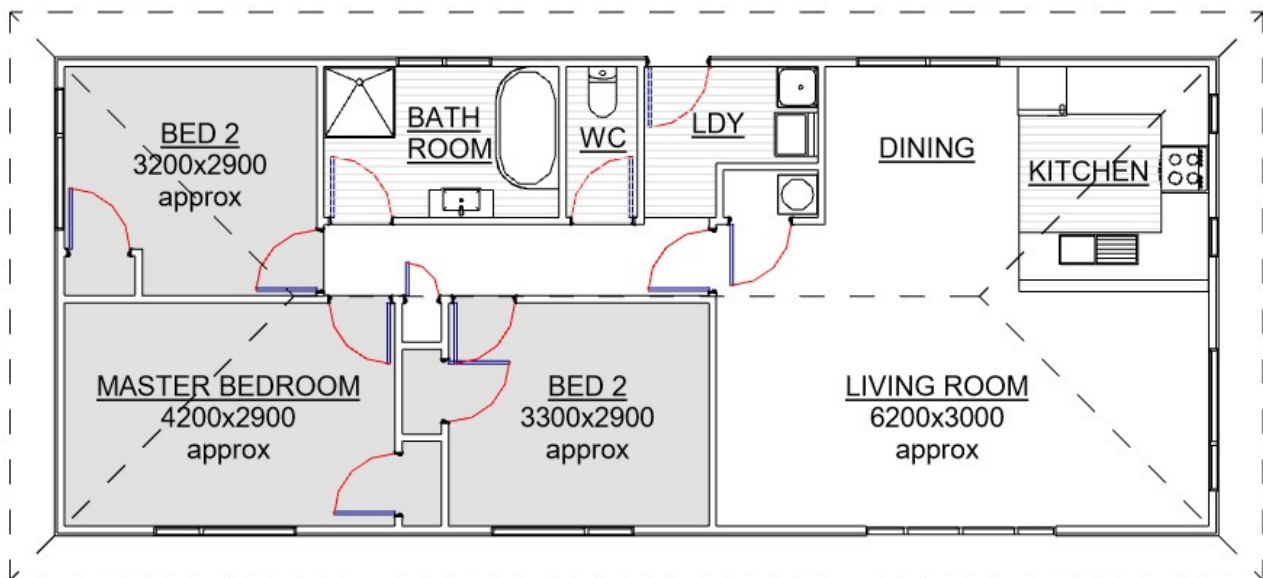

**BRANDERSON HOMES LTD**

TEL: 07 827 3901

EMAIL: [branderson@brandersonhomes.co.nz](mailto:branderson@brandersonhomes.co.nz)

WEBSITE: [www.brandersonhomes.co.nz](http://www.brandersonhomes.co.nz)

SHOW-HOME / OFFICE: 37 HAUTAPU ROAD CAMBRIDGE

Note: 3D images are artists impression only

# SPECIFICATIONS

Please note that these specifications are the standard for our on-site build homes.

Each contracted build can be individually tailored to meet your needs do please do not hesitate to suggest any changes you may have in mind.

## DOCUMENTS INCLUDED

WAIPA DISTRICT COUNCIL BUILDING PERMIT, PLANS & SPECS PROVIDED  
PLANS, SPEC & CALCULATIONS SUPPLIED FOR RECEIVING COUNCIL. ENGINEERS REPORT NOT INCLUDED

## EXTERIOR

SUBFLOOR  
TIMBER SUBFLOOR AS PER NZS 3604:2011 - FOUNDATIONS ARE BASED ON LEVEL OF SITE TO NZS 3604:2011

EXTERIOR CLADDING  
HARDIES 240 SMOOTH WEATHERBOARD OR HARDIES AXON PANELS

FRAMING  
90 x 45 H1.2 TREATED

FASCIA  
PRE PRIMED TIMBER FASCIA

ROOFING  
DIAMOND LONG RUN COLOURSTEEL CORRUGATED IRON OR STYLINE PROFILE.

WINDOWS  
TASMAN POWDER COATED DOUBLE GLAZED ALUMINIUM JOINERY  
IF APPLICABLE FRONT DOOR WILL BE POWDER COLOUR COATED TO SUIT

PAINT  
NOT INCLUDED ON STOCK HOMES UNLESS AN AGREEMENT HAS BEEN MADE PRIOR TO PURCHASE

## INTERIOR

FLOORING  
20MM PARTICLE BOARD FLOORING

DOOR HARDWARE  
WINDSOR FUTURA APWX LEVER RANGE

DOORS  
PRE-HUNG HUME PRIMECOAT MDF FLUSH IN SLIMELINE JAMBS & DOORSTOPS

LININGS  
ELEPHANT 10MM PLASTERBOARD & ELEPHANT 10MM AQUABOARD

PLASTERING  
LEVEL 4 - PAINT FINISH

CORNICE  
75mm GIB COVE CLASSIC

SKIRTING  
60mm FJ BEVELLED EDGE & 60mm FJ PINE ARCHITRAVES

SHELVING  
16mm WHITE PBD / LUMBERLOK CLOSET RAILS / 112x18mm FJ PINE SLATS IN H.W.C

## INSULATION

CEILINGS  
EARTHWOOL R3.6

WALLS  
EARTHWOOL R2.3

FLOOR  
EXPOL UNDERFLOOR R1.4

## BATHROOM

SHOWER  
ACRYLIC SHOWER UNIT - SIZE & SHAPE DICTATED BY PLAN

TOILET  
RAYMORE ATLANTA

BATH  
FREESTANDING BTW FIBERGLASS UNIT

VANITIES  
CERAMIC TOPPED UNITS, SUPPLIED & INSTALLED

TAPWARE  
RAYMORE RANGE

TOWEL RAIL  
HEATED

HEAT UNIT  
2KW WALL MOUNTED HEATER

EXTRACTION UNIT  
FAN/LIGHT UNIT

## KITCHEN

JOINERY  
PRIME MELAMINE or BESTWOOD MELTECCA, WATER-RESISTANT CARCASES

HARDWARE  
HERITAGE HARDWARE RANGE

BENCHTOPS  
PRIME LAMINATE or FORMICA RANGE

SINK  
STAINLESS STEEL PERO 800

## APPLIANCES

STOVE  
BOSCH ELECTRIC FREESTANDING WITH CERAMIC COOKTOP

OVEN  
BOSCH ELECTRIC UNDERBENCH OVEN

HOB  
BOSCH 4 ELEMENT CERAMIC COOKTOP

EXTRACTION UNIT  
BOSCH POWERPACK EXTRACTOR or ROBINHOOD RANGEHOOD

## LAUNDRY

TUB  
RAYMOR E6200

## WATER HEATER

ELECTRIC 180L MAINS PRESSURE CYLINDER

## ELECTRICAL

FIT-OUT COMPLETE USING LED LIGHTING. METER BOX INCLUDED  
HEAT PUMP TO SUIT ROOM LAYOUT

## PLUMBING

COMPLETED AND TESTED

Excluding structural building materials, all products mentioned may differ occasionally subject to availability and/or compatibility. When this is the case, the substitute product will always be of equal quality. All product warranties are subject to the distributors and/or manufacturers policies.

# BRANDERSON HOMES LTD